

ONDERVLOER

VOOR PVC/SPC KLIK- EN STICK-VLOEREN

UNDERLAY

FOR PVC/SPC CLICK- AND STICK FLOORING



- Eenvoudig op maat te knippen of snijden
- Easy to cut or trim to size
- Schone en snelle installatie
- Clean and fast installation

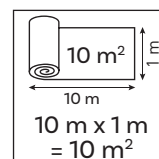
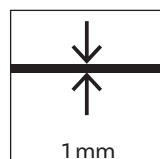
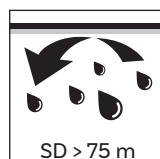
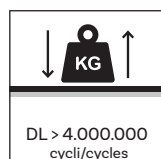
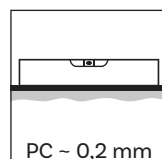
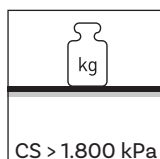
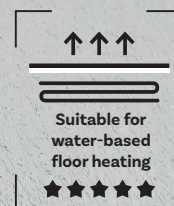
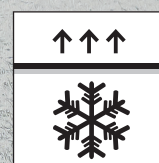
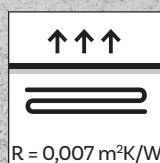

INSTALLATIEHANDLEIDING | INSTALLATION MANUAL

Volg altijd de instructies van de fabrikant!

Always follow the manufacturer's instruction!

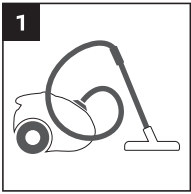

De ondervloer moet egaal, schoon, hard en droog zijn.

The base floor must be flat, clean, hard and dry.

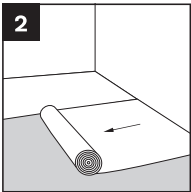

Rol de ondervloer uit op een droge betonvloer. De Aquastop-laag (de glimmende zijde), moet naar boven liggen.

Unroll the underlay on a clean and dry concrete floor. The Aquastop layer (the shiny side) should be facing up.

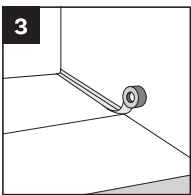

Plak de ondervloer tegen de muur met aluminium tape om volledige hydro-isolatie te krijgen.

To provide fully hydro-insulation stick the underlay to the wall using aluminium tape.

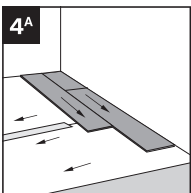

Plaats de vloer loodrecht op de ondervloer, volg de instructies die bijgeleverd zijn door de fabrikant.

Place the floor perpendicular to the underlay, follow the instructions provided by the manufacturer.

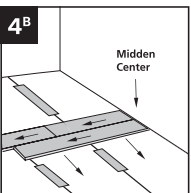

 **FETIM GROUP**

P.O. Box 770
1000 AT Amsterdam
info@fetimgroup.com

Made in Germany



www.blauer-engel.de/uz156

