

iD Evolution

MODULAR TILES

Mineral
strength.
Natural
design.

Building new ground

Step into the world of iD Evolution, our non-PVC collection of modular tiles made from **64% mineral content**, seamlessly combining **strength, durability and environmental consciousness**.

The pursuit of 'always more' is threatening our planet and we need to find a way to deliver more with less.

To be gentler on the planet's impact, the product is manufactured in a plant that uses 100% green electricity and installation offcuts are recyclable.

iD Evolution has also been designed with people's health and wellbeing in mind as it also ensures excellent **indoor air quality** through **ultra-low VOC emissions**.

Made of polypropylene, a material commonly used in car bumpers, iD Evolution is engineered to thrive in **high traffic environments**, ensuring suitability for a variety of spaces. From dynamic workplaces and nurturing higher educational environments to stores and shops, as well as for aged care, iD Evolution offers a versatile solution tailored to various settings.

The **glue-down installation method** promises endurance and long-lasting stability.

iD Evolution presents itself as **one modular non-PVC solution** for all your building renovation projects.

LOWER EMISSIONS



iD Evolution flooring production is using **100% green electricity**.



The installation offcuts are recyclable.

GREATER WELL-BEING



Lowering our environmental footprint will never mean compromising on **comfort, health or overall well-being**.



iD Evolution is **free of phthalates, halogens and solvents**.



iD Evolution contributes to greater well-being as it is odourless and improves **indoor air quality** through **ultra-low VOC emissions**.

MORE PROOF



We commit to only using good materials in total transparency throughout production. (Details listed in our PHD).



Our Product Health Declaration provides fully transparent **evidence of the product's health credentials**.



The way to better floors.



Minerality

iD Evolution boasts a high natural composition, with a **64% mineral content** sourced from two naturally occurring resources: chalk and brucite.

Robust for a long lifespan

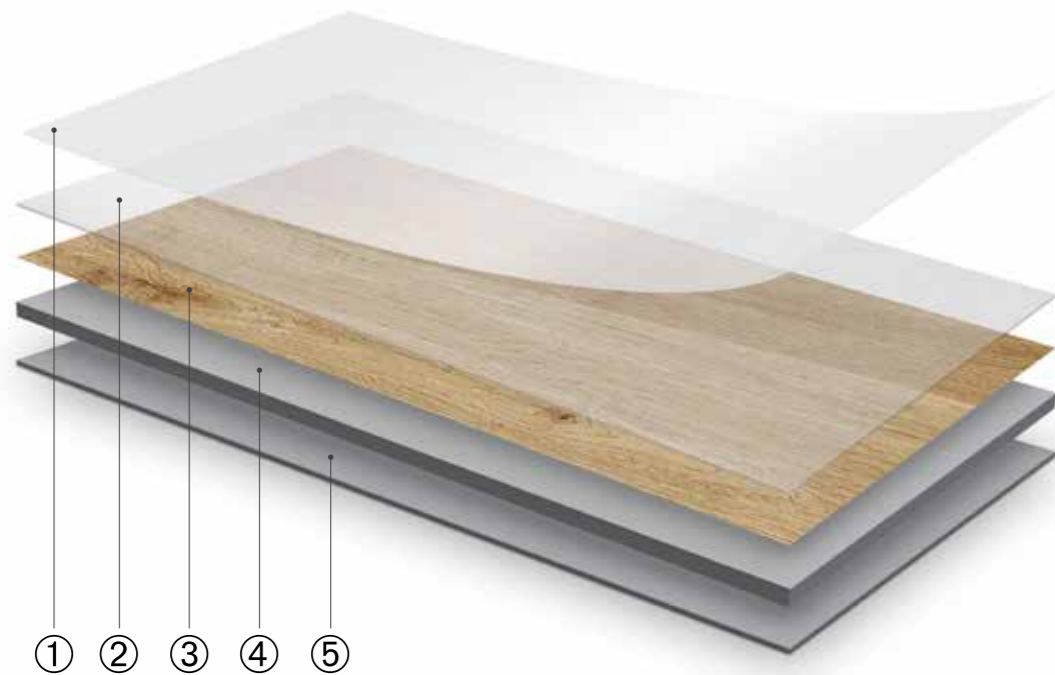

- ① **Top Coat:** imparts a matte finish to the flooring and provides exceptional scratch resistance.
- ② **Wear Layer:** enhances the texture of the design and significantly bolsters its resistance to wear and tear.
- ③ **Printed Film:** employs top-quality printing techniques to achieve an authentic and natural appearance.
- ④ **Core Layer:** delivers structural strength and durability, while also assisting in mitigating transfer effects resulting from surface irregularities.
- ⑤ **Backing Layer:** ensures dimensional stability and balance.

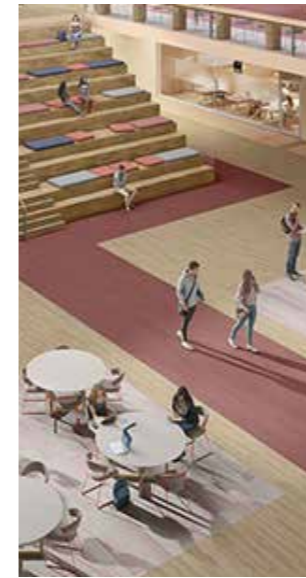

HIGH-TRAFFIC PERFORMANCES

iD Evolution stands as a rigidified product, tackling **high-traffic areas**.

Unequalled resistance to scratches, stains, wear, and abrasions makes it a durable solution for your flooring needs.

A warranty **securing your investment** for years to come, making it an ideal choice for any space.

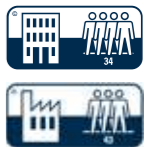

GLUE-DOWN INSTALLATION

Greater stability and less susceptibility to expansion and contraction resulting from fluctuations in temperature and humidity. The secure bond to the subfloor guarantees **no shifting or movement over time**.

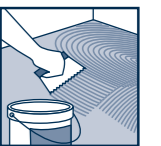

EASY MAINTENANCE

A floor that lasts longer, with no need for harsh detergents and aggressive products. iD Evolution achieves **the best industry standards for soiling and cleaning**.



10 great designs

With iD Evolution, you can create a sleek and stylish aesthetic, whether you prefer the warmth of wooden décors or the contemporary appeal of concrete tiles.

Our matt finish and embossing techniques guarantee **authentic and natural décors**.

Formats

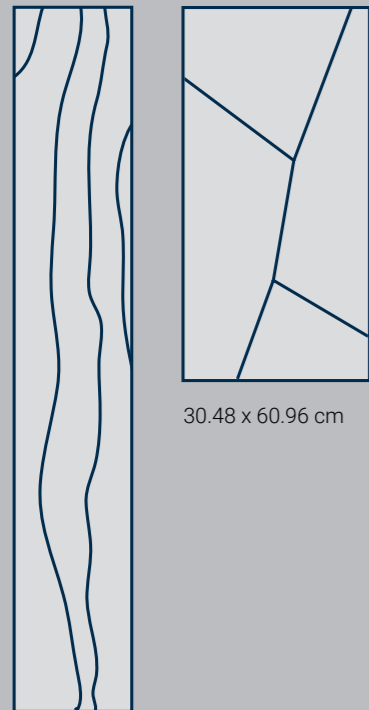

121.92 x 18.41 cm

Planks

Kiel Oak



Chambord Oak



Tiles

Dublin Concrete



Oslo Concrete



The background of the page is a collage of textures. On the left, there are two overlapping rectangular panels with a grey, stone-like texture. On the right, there are two overlapping rectangular panels with a light brown wood grain texture. The panels are arranged in a way that they appear to be layered and slightly offset from each other.

Capturing the elegance of wood and stone

The iD Evolution range draws its inspiration from the most exquisite colours and designs found within our best-selling collections.

Its decorative patterns have been thoughtfully curated to offer **adaptable solutions for a wide spectrum of interior designs**, creating dynamism and style from the simplicity of Scandinavian minimalism to the opulence of French luxury, all with a touch of refined classicism.

These times are defined by a growing desire for **natural elements, and the biophilic trend** is gaining momentum.

iD Evolution has been meticulously crafted with this in mind, featuring **a natural colour palette** enriched with subtle yet inviting shades of warm grey.



KIEL OAK Brown | 260036 008



CHAMBORD OAK Honey | 260036 003
DUBLIN CONCRETE Grey | 260037 010



CHAMBORD OAK Natural | 260036 002



CHAMBORD OAK White | 260036 005
KIEL OAK Grey | 260036 007



OSLO CONCRETE Light grey | 260037 009
KIEL OAK Grey | 260036 007



DUBLIN CONCRETE

The classic and delicate grey structure of Dublin concrete enables a realistic, smooth concrete floor effect. Whether you're aiming for an industrial or street-inspired look, or aligning with clean or craft trends, this texture is the optimal choice to elevate the personality of your projects.

Dimensions:
30.48 x 60.96 cm

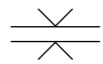

2.5 mm

LRV: 21.90%

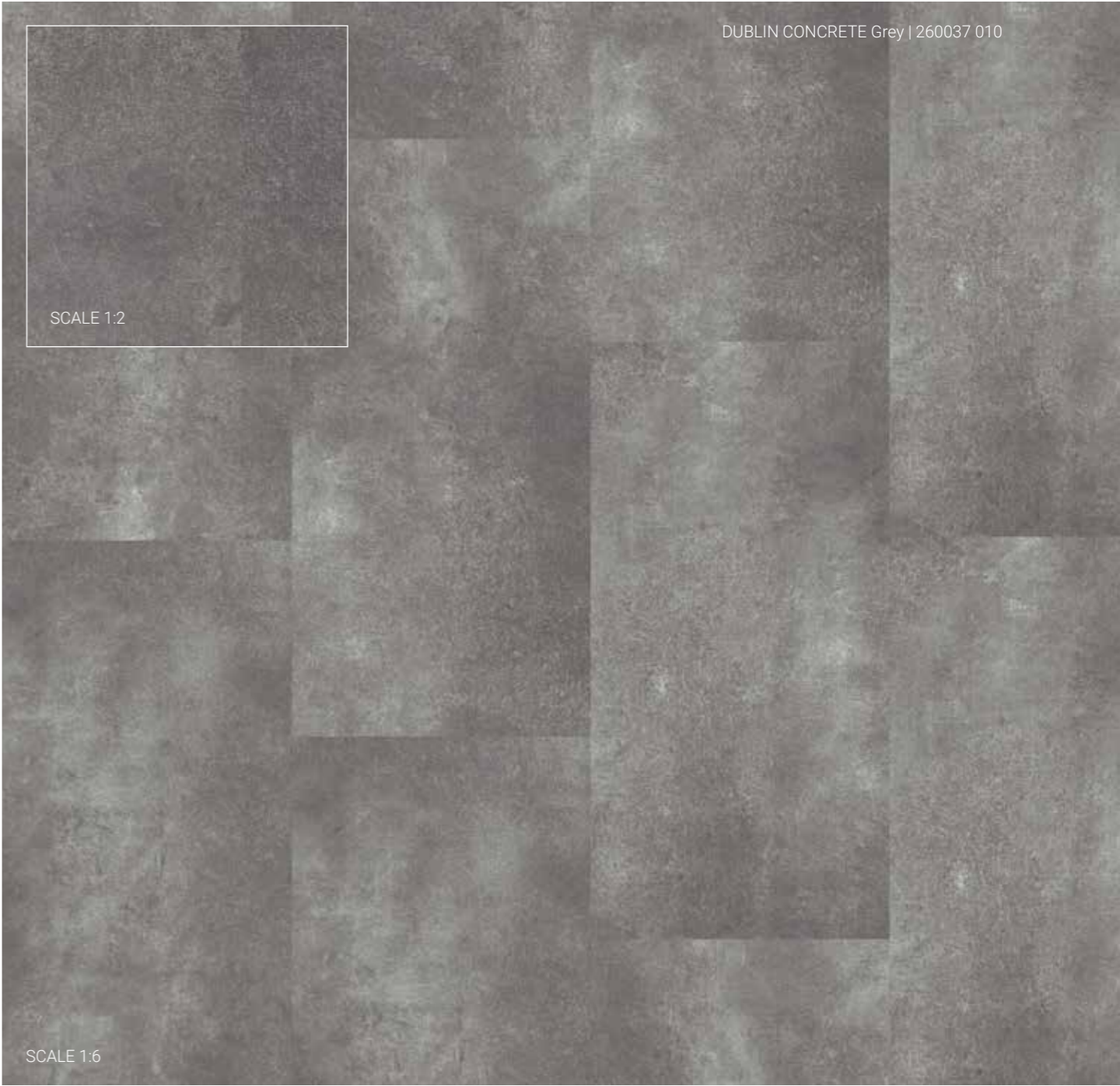

OSLO CONCRETE

Oslo concrete offers a soft and light mineral texture throughout. With its pure and subtle surfaces, this flooring provides an easy-to-combine solution that suits a wide range of trends and styles.

Dimensions:
30.48 x 60.96 cm

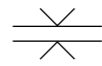

2.5 mm

LRV: 34.48%

OSLO CONCRETE Light Grey | 260037 009



SCALE 1:6



KIEL OAK

Kiel City serves as a gateway to Scandinavia.

Much like this city positioned at the crossroads of two worlds, the appearance of this wood seamlessly blends classicism with Scandinavian softness. The texture of this premium wood is delicately white-oiled, exhibiting a palette of subdued yet lively colors.

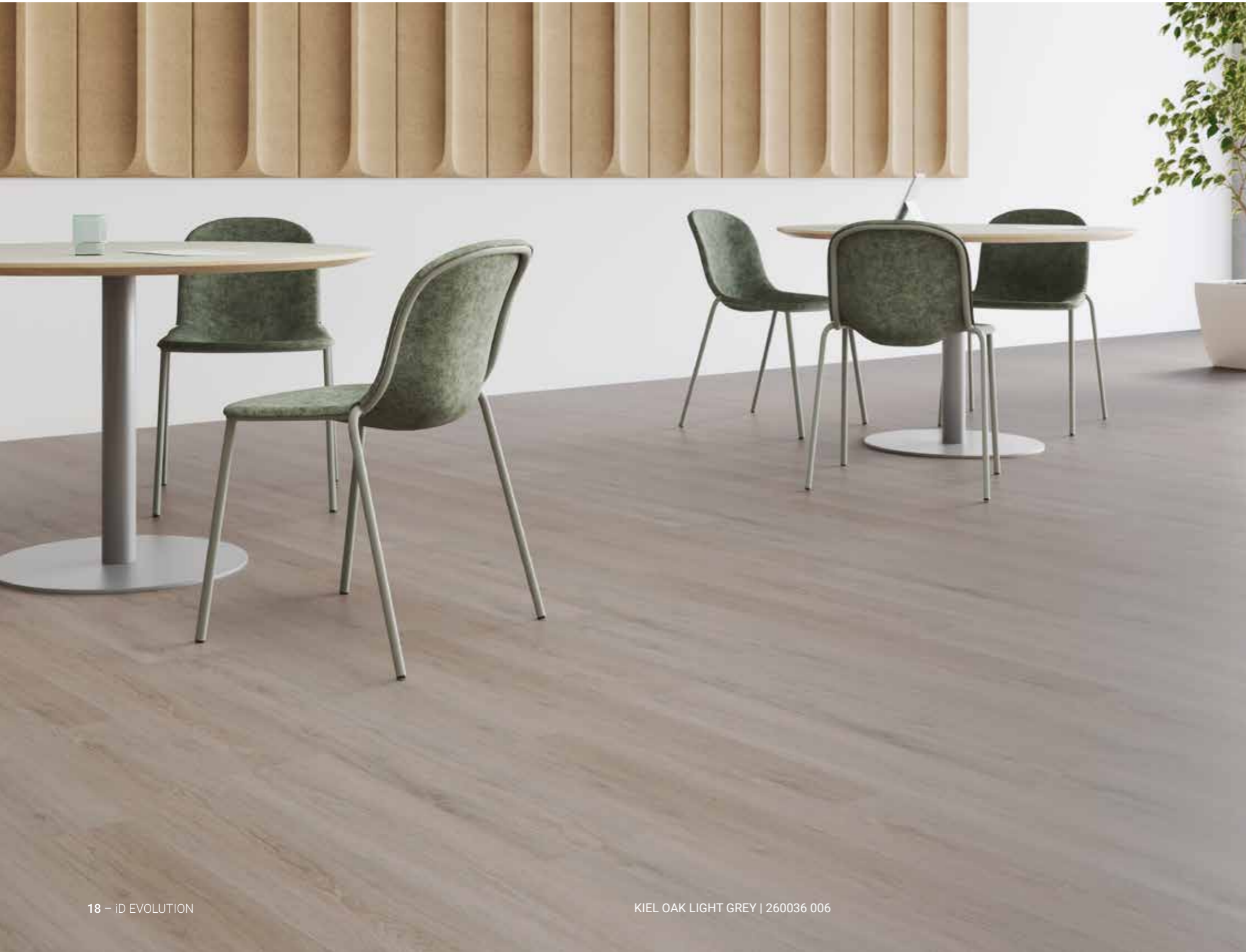

Dimensions:
121.92 x 18.41 cm

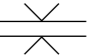
 2.5 mm



LIGHT GREY | 260036 006

LRV: 32.95%



GREY | 260036 007

LRV: 18.72%



BROWN | 260036 008

LRV: 13.04%

KIEL OAK Light Grey | 260036 006



SCALE 1:2

SCALE 1:6

KIEL OAK Grey | 260036 007



SCALE 1:2

SCALE 1:6

KIEL OAK Brown | 260036 008



SCALE 1:2

SCALE 1:6

CHAMBORD OAK

The rustic texture of Chambord Oak reveals a diverse spectrum of color shades, accompanied by intricate cathedral-like patterns gracefully adorning the planks.

The selection of five natural tones within the color range offers a delightful array of options to discover the perfect complement for any room.

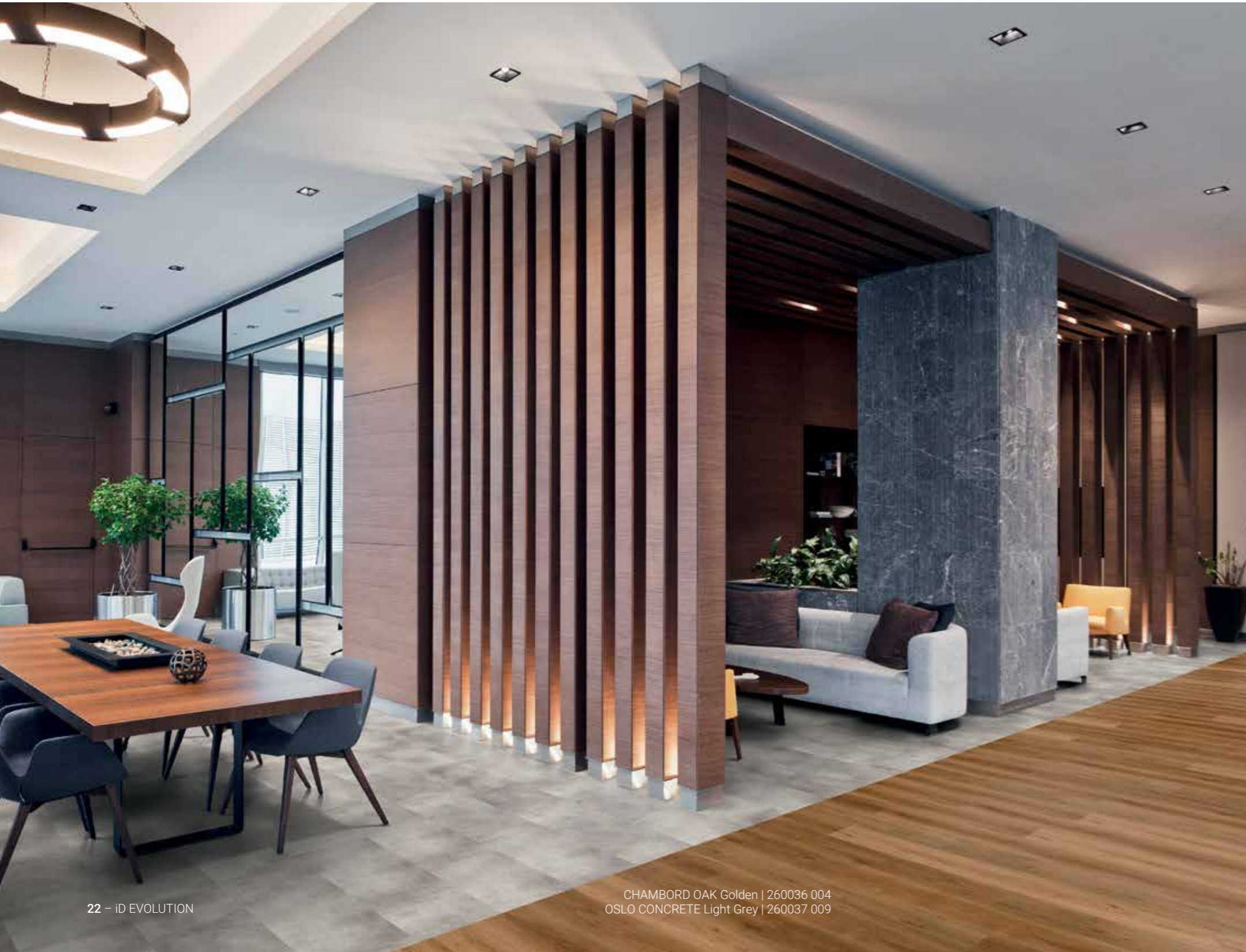

Dimensions:
121.92 x 18.41 cm

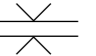
 2.5 mm



WHITE | 260036 005

LRV: 45.43%



BEIGE | 260036 001

LRV: 25.74%



NATURAL | 260036 002

LRV: 29.26%



HONEY | 260036 003

LRV: 30.73%



GOLDEN | 260036 004

LRV: 20.11%

CHAMBORD OAK Beige | 260036 001



SCALE 1:2

SCALE 1:6

CHAMBORD OAK White | 260036 005



SCALE 1:2

SCALE 1:6

CHAMBORD OAK Natural | 260036 002



SCALE 1:2

SCALE 1:6

CHAMBORD OAK Golden | 260036 004

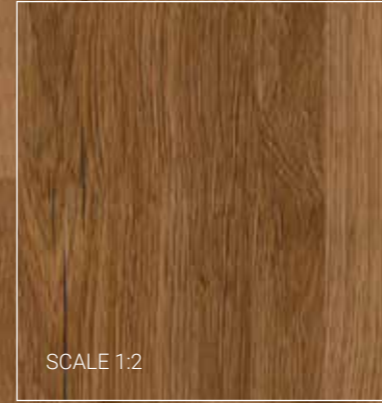

SCALE 1:2

SCALE 1:6

CHAMBORD OAK Honey | 260036 003



SCALE 1:2

SCALE 1:6

Accessories

Non-PVC decorative skirting

1411900



Material: White Polystyrene 100% recyclable minimum 30 % of recycled content

Colour: Pre painted in white. Can be repainted

Size: 2400 length x 13 thickness x 60 height mm

Packaging: 1 box of 6 pieces (14.4 ml linear meters)

MAKING THE RIGHT CHOICE WHILE RESPECTING THE ENVIRONMENT



Zero waste
in production



Very low VOC
emissions



Resource-conserving
and environmentally
friendly manufacturing process



20% of which
are produced
by solar panels



Recycled carton
packaging





Technical information

CLASSIFICATION		STANDARD
Type of floor covering	ISO 19322	Resilient Floor covering based on thermoplastic polymers
Classification	EN ISO 10874	Commercial: 34 Industrial: 43
TECHNICAL CHARACTERISTICS		
Total thickness	EN ISO 24346	2.50 mm
Total weight	ISO 23997	4100 g/sqm
Dimensions	EN ISO 24342 Planks	121.92 cm x 18.41 cm
	EN ISO 24342 Tiles	30.48 cm x 60.96 cm
Surface treatment	-	Matt
TECHNICAL PERFORMANCES		
Dimensional stability 6h 50°C	ISO 23999 - B method	≤ 0.15%
Curl 6h 50°C	ISO 23999 - B method	≤ 2 mm
Reaction to fire	EN 13501	Cfl-s1
Residual indentation	ISO 24343-1	≤ 0.10 mm
Furniture leg	ISO 16581	No damage
Castor chair	EN ISO 4918	No damage after 25 000 cycles
Light fastness	EN ISO 105-B02 (method 3a)	≥ 6
Chemical resistance	EN ISO 26987	Not affected (0)
Slip resistance	EN 16165	R10
	EN 13893	μ ≥ 0.30
Underfloor heating	-	Suitable - Max 27°C
CE MARKING		
DoP number	0132-0092-DoP-2023-09	
SUSTAINABILITY		
VOC emissions	ISO 16000	≤ 10 μg/m ³ after 28 days
REACH	Compliant (PHD available)	
Recyclability	Post installation waste	
Carbon Footprint (Cradle-to-Gate, EPD Modules A1-A3)	Available once EPD published	
Warranty		
Commercial Warranty	10 years	

The above information is subject to modification for the benefit of further improvement. (12/20). According to the European Regulation N°305/2011 for CE Marking, the Declarations of Performance are available on our website www.tarkett.com. Tarkett's instructions regarding installation, cleaning and maintenance should be observed. Please contact Tarkett at the address shown for these instructions.





■ **WESTERN EUROPE:** Austria: Tarkett Holding GmbH - Tel. +43 1 716 440 ■ Belgium: Tarkett Belux Sprl - Tel. +32 52 26 24 11 ■ Denmark: Tarkett A/S - Tel. +45 43 90 60 11 ■ Finland: Tarkett Oy - Tel. +358 9 4257 9000
 ■ France: Tarkett SAS - Tel. +33 1 41 20 42 49 ■ Germany: Tarkett Holding GmbH - Tel. +49 621 68172 300 ■ Greece: Tarkett Monoprosopi Ltd - Tel. +30 210 6745 340 ■ Italy: Tarkett S.p.A. - Tel. +39 0744 7551 ■ Luxembourg: Tarkett GDL SA - Tel. +352 949 211 8804 ■ Netherlands: Tarkett BV - Tel. +31 416 685 491 ■ Norway: Tarkett AS - Tel. +47 32 20 92 00 ■ Portugal: Tarkett SA - Tel. +351 21 427 64 20 ■ Spain: Tarkett Floors S.L. - Tel. +34 914 951 400
 ■ Sweden: Tarkett Sverige AB - Tel. +46 771 25 19 00 ■ Switzerland: Tarkett Holding GmbH - Tel. +41 43 233 79 24 ■ Turkey: Tarkett Turkey - Tel. +90 212 213 65 80 ■ United Kingdom: Tarkett Ltd - Tel. +44 (0) 1622 854 040
 ■ **EASTERN EUROPE:** Baltic Countries: Estonia: Tel. +372 55 51 5880 ■ Latvia: Tel. +371 26 112014 ■ Lithuania: Tel. +370 37 262220 ■ Czech Republic: Tarkett org. složka - Tel. +420 271 001 600 ■ Hungary: Tarkett Polska Sp.z.o.o. magyarországi fióktelepe - Tel. +36 1 437 8150 ■ Kazakhstan: Tarkett Kazakhstan - Tel. +7 7172 79 00 99 ■ Poland: Tarkett Polska Sp. z o. o. - Tel. +48 22 16 09 231 ■ Russian Federation: ZAO Tarkett RUS - Tel. +7 495 775 3737 ■ Slovakia: Tarkett Polska Sp. z o. o. organizačná zložka - Tel. +421 2 48291 317 ■ South East Europe: Tarkett SEE - Tel. +381 21 7557 649 (44) 569 12 21 ■ Ukraine: Tarkett UA - Tel. +38 (0) 44 35 45 621 ■ **ASIA AND OCEANIA:** Australia: Tarkett Australia Pty Ltd - Tel. +61 2 88 53 12 00 ■ China: Tarkett Floor Covering (Shanghai) Co. Ltd. - Tel. +86 (21) 60 95 68 38 ext 841 ■ North East Asia: Tarkett Hong Kong Limited - Tel. +852 2511 8716 ■ India: Tarkett Flooring India Pvt. Ltd. - Bangalore - Tel. +91 80 4130 3793 - New Delhi - Tel. +91 11 4352 4073 - Mumbai - Tel. +91 22 2648 8750 ■ South East Asia: Tarkett Flooring Singapore Pte. Ltd. - Tel. +65 6346 1585 ■ **AFRICA:** Tarkett International: Tel. +33 1 41 20 41 01 ■ **MIDDLE EAST:** Tarkett Middle East: Tel. +961 1 51 3363/4 ■ Israel: Tarkett International: +33 1 41 20 41 01 ■ **NORTH AMERICA:** USA: Tarkett Inc. - Tel. +1 713 869 5811 / Johnsonite - Tel. +1 440 543 8916 ■ Canada: Tarkett Inc. - Tel. +1 450 293 173 ■ **LATIN AMERICA:** Brazil: Tarkett Brasil: Tel. +55 12 3954 7108 ■ Argentina - Chile - Uruguay: Tarkett Mercosur - Tel. +54 11 47 08 07 72 / +54 9 11 44 46 88 82
 ■ Bolivia - Colombia - Ecuador - Panama - Paraguay - Peru - Trinidad and Tobago - Venezuela: Tarkett Latam - Tel. +55 11 98410 9310 / +55 11 95494 0069 ■ Mexico / Central America: Tarkett Mexico - Tel. +55 11 98410 9310

Designs and photos used in this brochure are for illustration purposes only. Images are not contractual images and do not stand for product recommendation. Due to evolution of standards, characteristics indicated in the text and images are not binding only after confirmation by our departments.

Design: Tarkett Internal Agency / Photos & 3D: 3DStudio - Shutterstock
professionals.tarkett.com

