

Flat Plate Collector EURO L20/L40 MQ



Wagner Solar

ENERGIETECHNIK
ENERGY TECHNOLOGY
TECHNOLOGIE ÉNERGÉTIQUE
ENERGIETECHNIEK



Now with new
tool-less plug
connection

The **EURO L20/L40 MQ** is a highly efficient flat plate collector for horizontal installation. Connected in long collector rows it delivers high yields for DHW preparation and space heating support.

STANDOUTS

- Tried quality
- Long collector rows
- Visually appealing
- Certified mounting systems

DETAILS

High-quality material, such as a strong aluminum encasing and anti reflective glass with exceptional transmittance (EURO L20 MQ), guarantee a top position among collectors - the result of more than 30 years experience in collector development.

Its special absorber geometry allows the side-by-side parallel connection of up to 10 collectors in a row.

A slim design and small spacings between collectors in combination achieve a visually appealing impression.

Our carefully designed TRIC family of mounting systems guarantee the durable setup of your solar installations. The roof parallel and free standing mounting kits are TÜV certified for structural safety.



Flat Plate Collector EURO L20/L40 MQ

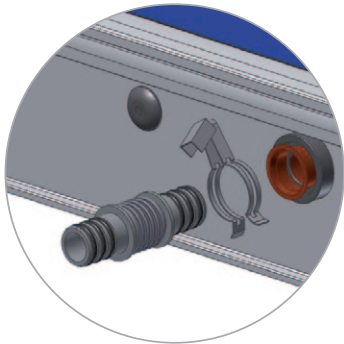

Toolless connection technology and heat expansion compensators



The TRIC mounting system – quickly and safely installed. With general German type approval.

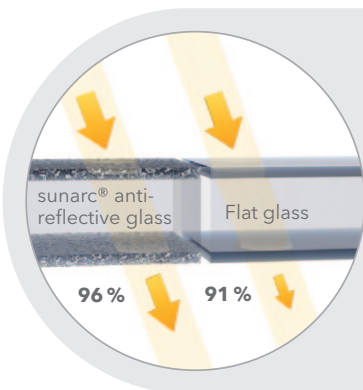

Applications

- Solar domestic hot water supply and space heating supply
- Commercial applications, i.e. hotels, hospitals, process heat
- Collector field areas up to 50 m² can be reached by combining serial and parallel connections

Installation

- Horizontal orientation
- Roof parallel and free standing setup

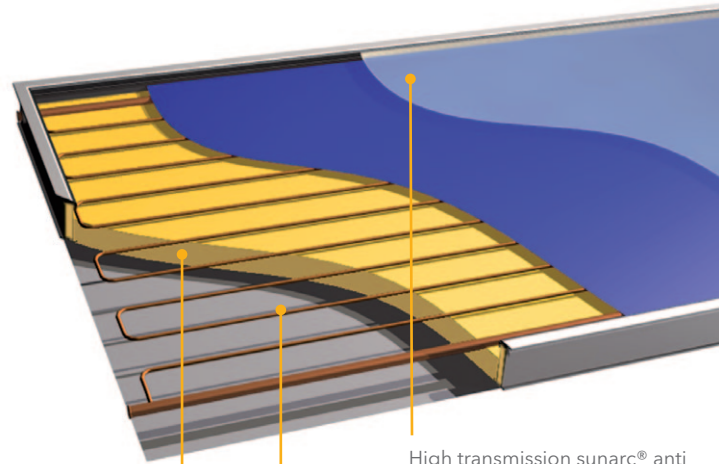

High transmission sunarc® anti reflection glazing (L20 MQ)

Serpentine absorber with continuous header pipes – for easy system design and piping.

Seamless extra strong 60 mm side and back insulation minimizes the collectors heat loss

UP TO 10 % MORE YIELD WITH sunarc® ANTI REFLECTIVE GLASS

On the inner and outer glass boundaries sunarc® anti reflection glass features nano structures that significantly reduce reflection and thus increase the glazing's transmittance from the common 91 % of standard solar glass to 96 %. The improvement is especially effective at low incidence angles as they often occur during Winter and transition

seasons, where it notably extends the „solar period“, even for small systems. Annually the sunarc® anti reflection glass increases the yield by 10 %!

More information at:
www.wagner-solar.com

| Technical data | EURO L20 MQ AR | EURO L40 MQ HTF |
|---|---|--|
| Collector area | gross 2,62 m ² / aperture 2,37 m ² | gross 2,61 m ² / aperture 2,37 m ² |
| Dimensions (L x W x H) | 2151 x 1215 x 110 mm | 2151 x 1215 x 80 mm |
| Glazing | Highly transparent sunarc® anti reflective glass, $\tau = 96\%$ | 4 mm solar safety glass; $t = 91\%$ |
| Absorber | Laser fused serpentine absorber with highly selective vacuum coating; $\alpha = 95\%$; $\varepsilon = 5\%$ | |
| Annual collector yield (Solar Keymark, Würzb., $T_m = 50^\circ\text{C}$) | 1279 kWh/a | 1167 kWh/a |
| Encasing | Aluminum (silver or black) with seamless side and 60 mm backside insulation | Aluminum (silver) with seamless side and 30 mm backside insulation |
| Weight | 52,4 kg | 44 kg |