



**8 mm Long plank AC5**

**195 x 2003 mm | 7.68" x 78.86"**

<b>★30★</b> Year Warranty	 Organic Rigid Board	 A.B.C. Anti Bacterial Comfort	 Pet Proof	 EN 13329
 Light-Resistant	 Microscratch Protect	 Anti-Static	 Authentic Embossed	
 V-Groove	 1cllc 2go pure+			

30 year residential warranty, 5 year commercial warranty<sup>\*1</sup> • Organic Rigid Board without PVC<sup>\*2</sup> • A.B.C. Antibacterial surface<sup>\*3</sup> • Pet proof • Light-resistant and colorfast, no fading if exposed to sunlight<sup>\*4</sup> • Especially durable surface protects the floor against microscratches • Guaranteed lifetime integrated Anti-Static effect • Bevelled edges for an authentic look • Surface water protection thanks to O.R.C.A. Moisture Defense Technology • Extra tight 1cllc 2go pure+ locking system

30 Jahre Garantie im Wohnbereich und 5 Jahre im gewerblichen Bereich<sup>\*1</sup> • Organic Rigid Board ohne PVC<sup>\*2</sup> • A.B.C. Antibakterielle Oberfläche<sup>\*3</sup> • Gut geeignet für Haustiere • Lichtbeständig und farbecht bei Sonneneinstrahlung<sup>\*4</sup> • Strapazierfähige Oberfläche schützt den Boden vor Mikrokratzern • Garantiert dauerhafte antistatische Wirkung • Umlaufende V-Fuge • Spritzwasserschutz dank O.R.C.A. Moisture Defense Technology • Extra stabiles 1cllc 2go pure+ Verriegelungssystem

30 ans de garantie pour usage domestique, 5 ans de garantie pour usage commercial<sup>\*1</sup> • Panneau rigide organique sans PVC<sup>\*2</sup> • A.B.C. surface anti-bactérienne<sup>\*3</sup> • Convient pour les animaux domestiques • Résistant à la lumière et grand teint sous la lumière directe du soleil<sup>\*4</sup> • Surface durable protégeant le sol des micro égratignures • Effet antistatique durable et garanti • Joint en V périphérique pour un look Authentique • Protection contre les éclaboussures grâce à la Technologie de Protection contre l'Humidité O.R.C.A. • Système de verrouillage ultra stable 1cllc 2go pure+

Garantía residencial de 30 años, garantía comercial de 5 años<sup>\*1</sup> • Tablero orgánico rígido sin PVC<sup>\*2</sup> • A.B.C. superficie antibacteriana<sup>\*3</sup> • Muy adecuado para mascotas • Resistente a la luz y sin cambios de color por radiación solar<sup>\*4</sup> • Superficie resistente que protege el piso de micro rasguños • Efecto antiestático de larga duración garantizado • Bisel en V a cuatro lados para darle un aspecto autentico • Protección contra salpicaduras de agua gracias a la Tecnología de Defensa contra la Humedad O.R.C.A. • Sistema de ensamble 1cllc 2go pure+ extra-estable

**Acoustic underlay recommendation:** „Pur 1.0“ for floors with O.R.C.A. Moisture Defense Technology  
**Empfehlung Dämmunterlage:** „Pur 1.0“ für Böden mit O.R.C.A. Moisture Defense Technology  
**Sous-couche de recommandation:** « Pur 1.0 » pour les sols avec O.R.C.A. Technologie de Protection contre l'Humidité  
**Recomendación para la base aislante:** „Pur 1.0“ para pisos con Tecnología de Defensa contra la Humedad de O.R.C.A.

<sup>\*1</sup> According to the conditions of warranty - Gemäß Garantiebestimmungen  
<sup>\*2</sup> Conforms to the guarantee clauses - Conforme a las condiciones de la garantía  
<sup>\*3</sup> Consists of natural wood and an organic chemical binder. May contain traces of PVC from E.e. packaging. - Besteht aus natürlichem Holz und organischem Bindemittel. Kann Spuren von PVC enthalten, z. B. von der Verpackung. - Se compose de bois naturel et de liants chimiques organiques. Peut contenir des traces de PVC provenant par ex. emballage. - Fabricado con madera natural y compuesto químico orgánico. Puede contener trazas de PVC, p. ej. del embalaje.  
<sup>\*4</sup> Tested germs - Getestete Bakterien - Germes testés - Bacterias analizadas: Staphylococcus aureus  
<sup>\*5</sup> According to Level 6 of the Blue Wool Scale (method for calculating light-resistance) - Gemäß Stufe 6 der Blauwollskala (Methode zur Berechnung der Lichtechtheit) - Conformément au niveau 6 sur l'échelle des bleus (méthode de calcul de la résistance à la lumière) - Conforme al nivel 6 de la escala de azules (método de cálculo de la resistencia a la luz)

**Spritzwasserschutz Feuchte-schutz-Technologie, 100 h+ garantiert\***  
**Protection de la surface contre des éclaboussures, technologie de protection contre l'humidité, 100 h+ garanties\***  
**Protección contra salpicaduras de agua, tecnología con resistencia contra la humedad, garantizada por 100 h+\***



Made in Germany • Fabriqué en Allemagne  
[www.krono-original.com](http://www.krono-original.com)

\* 24 h geschützt gegen Spritzwasser gemäß NALFA (North American Laminat Floor Association) und zusätzlich 100 h+ gemäß KRONOSPAN Werksnorm WN-101, www.100hour-test.com  
\* Protection de 24 h de la surface contre l'eau aux termes de la NALFA (North American Laminat Floor Association) avec 100 h+ de protection supplémentaires de la surface contre l'eau d'après la norme d'ouvrage standard KRONOSPAN WN-101, www.100hour-test.com  
\* 24 h de protección contra salpicaduras de agua conforme a NALFA (North American Laminat Floor Association) y además 100 h+ conforme a la norma de fabricación de KRONOSPAN WN-101, www.100hour-test.com

Производители: ООО КроноФлооринг; Германия, Виссентен; България ЕООД; Кроноспан; Украина, Индустриальна зона Веркила, Тен. 02/4001783 - Importer na Polskę: Kronospan KO Sp. z o.o. ul. 1 Maja 52, 47-100 Strzelce Opolskie, Polska - Importer: Falco Zrt. H-9700 Szombathely, Zaráti út 26 - Importator pentru România: Kronospan Trading SRL, Sebes, Str. Mihail Kogălniceanu, nr. 59, et.1, cam. 1/12 Tel: 0040 258 801 190, Fax: 0040 258 801 199 - Manufacturer: Kronoflooring GmbH, Germany, Importer: Kronospan Ltd., 1 Hollyhead Road, Chirk, Wrexham LL14 5RT, United Kingdom, tel: +44 1691 77 33 61, fax: +44 1691 77 32 92, info@kronospan.co.uk

**WARNING:** Drilling, sawing, sanding or machining wood products can expose you to wood dust, a substance known to the State of California to cause cancer. Avoid inhaling wood dust or use a dust mask or other safeguards for personal protection. For more information go to [www.P65Warnings.ca.gov/wood](http://www.P65Warnings.ca.gov/wood). ATTENTION: Percer, scier, poncer ou usiner des produits en bois peuvent vous exposer à la poussière de bois, une substance connue dans l'État de Californie pour causer le cancer. Évitez d'inhaler la poussière de bois ou utilisez un masque à poussière ou d'autres moyens de protection. Pour plus d'informations, consultez le site: [www.P65Warnings.ca.gov/wood](http://www.P65Warnings.ca.gov/wood)

EN 14041:2004/AC:2006; C<sub>1</sub>F1+; E1; DS; PCP < 5ppm; 0,08 W/(m.K), Bodenbeläge für die Verwendung in Gebäuden, DoP: LW0022017/NB 0766; NB 0767; DoC: LWUK022022; UK AB 0321 Kronoflooring GmbH, Muhlbacher Str. 1, 01561 Lampertswalde, Germany DoP/DoC: [www.floor-installation.com](http://www.floor-installation.com)

**UK CA** **CE** **22** **17**

**kronospan**



**eng** Before installing the floor, please also refer to the online installation instructions: [www.floor-installation.com](http://www.floor-installation.com) **NOTE!** Please check all panels for defects before installation. Any panels with visual defects (visible from a height of 1.5 m / 5 ft) should not be installed. **deu** Vor dem Verlegen bitte auch die Online Verlegeanleitung beachten unter: [www.floor-installation.com](http://www.floor-installation.com) **HINWEIS!** Bitte Paneele vor dem Verlegen kontrollieren. Bei evtl. Oberflächenfehlern (müssen erkennbar sein aus einer Abstandshöhe von 1,5 m) die betroffenen Paneele aussortieren! **fra** Avant la pose, consultez les instructions de pose en ligne : [www.floor-installation.com](http://www.floor-installation.com) **ATTENTION!** Vérifiez les lames avant la pose. Une lame présentant un défaut visible (d'une hauteur de 1,5 m) ne doit pas être installée. **spa** Antes de colocar el producto, tenga en cuenta las instrucciones de colocación online disponibles en: [www.floor-installation.com](http://www.floor-installation.com) **NOTA!** Inspeccione los paneles antes de colocarlos. En caso de que existan fallos en la superficie (deberán poder reconocerse desde una altura de 1,5 m), excluir los paneles afectados.

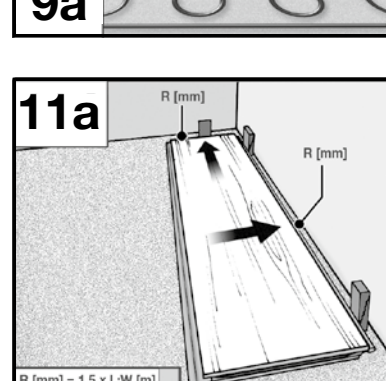
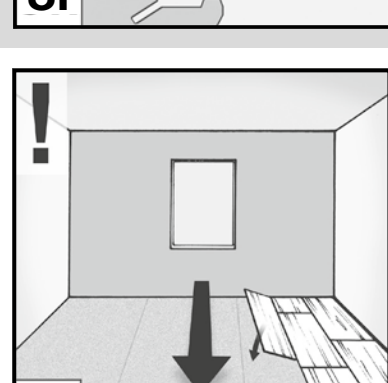
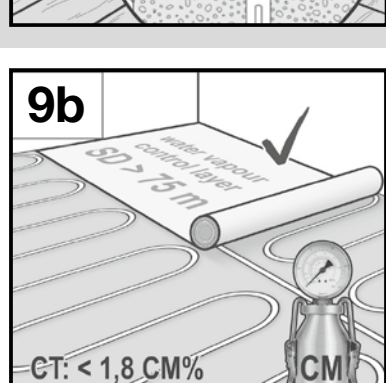
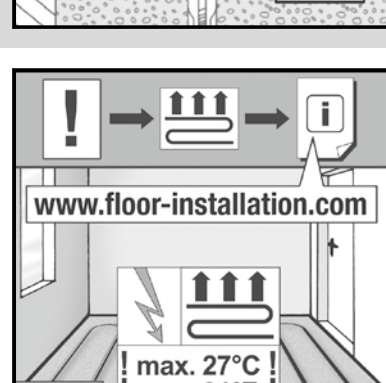
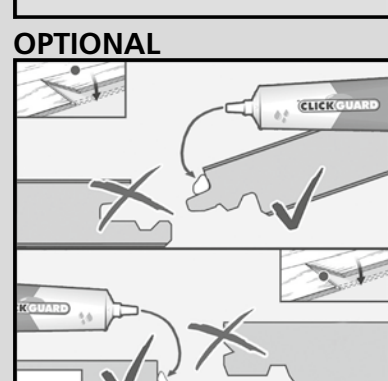
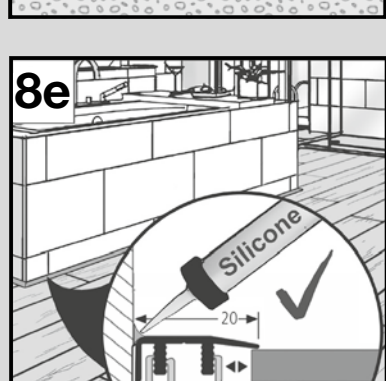
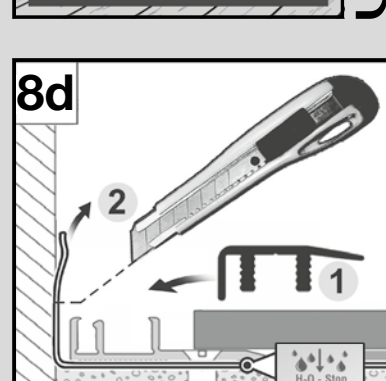
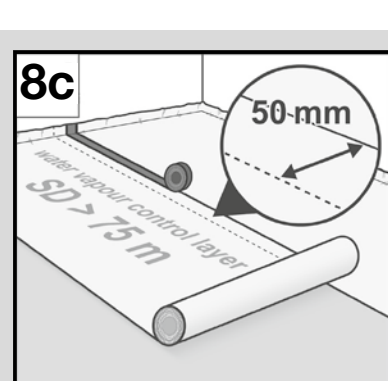
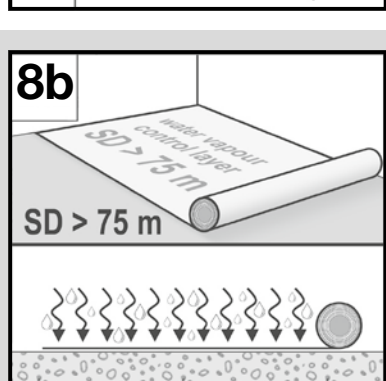
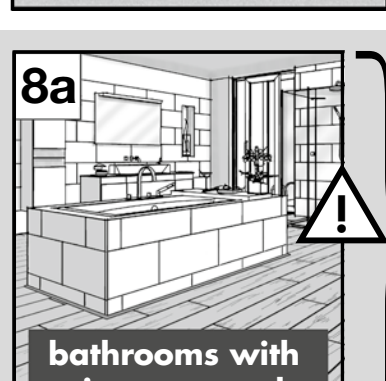
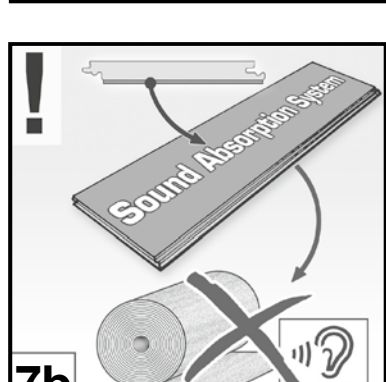
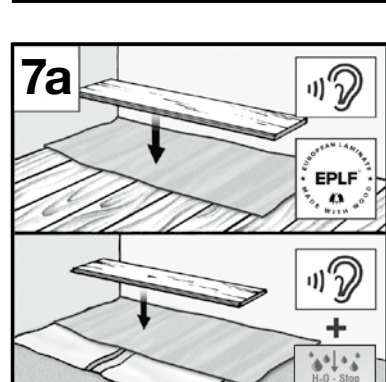
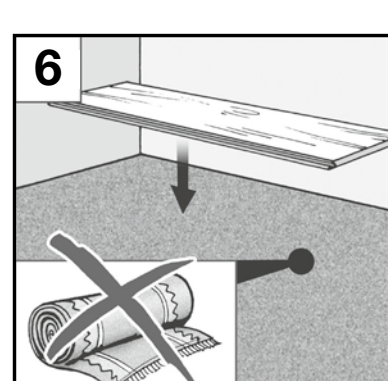
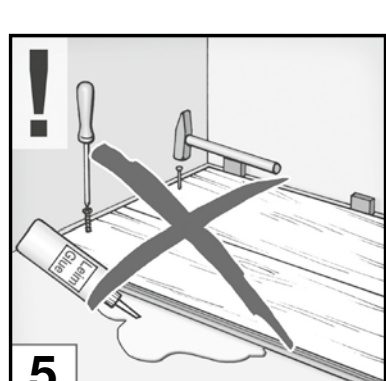
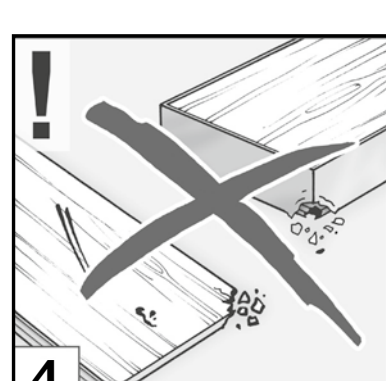
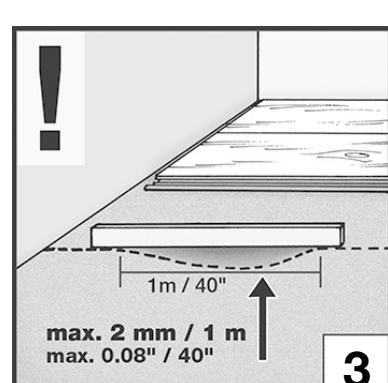
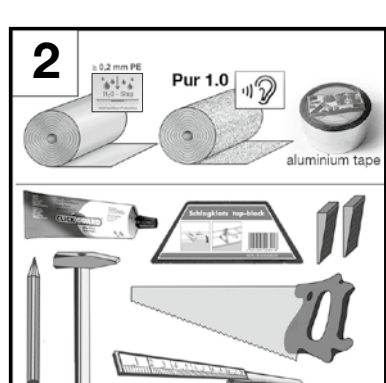
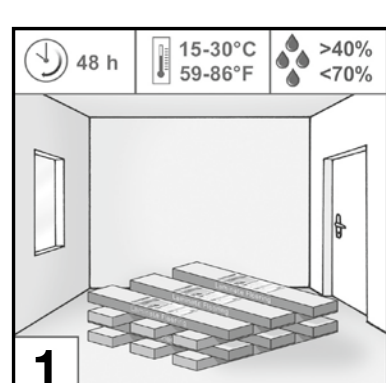

Length (L) Width (W)	R (min. 12 mm)
8 m	12 mm
10 m	15 mm
12 m	18 mm
15 m	23 mm

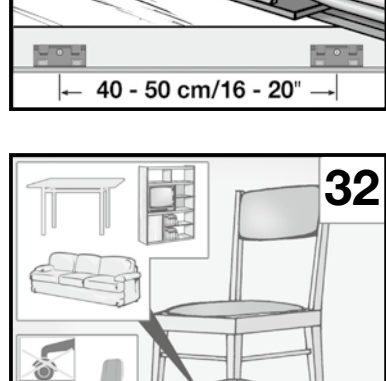
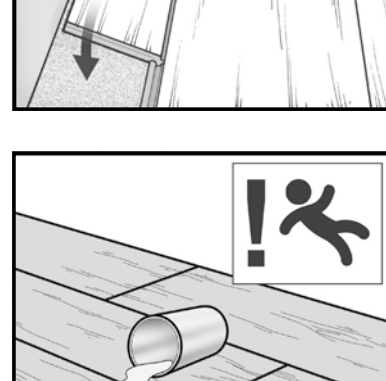
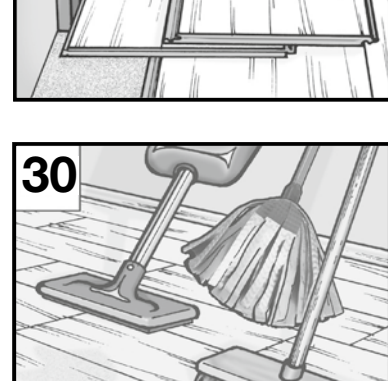
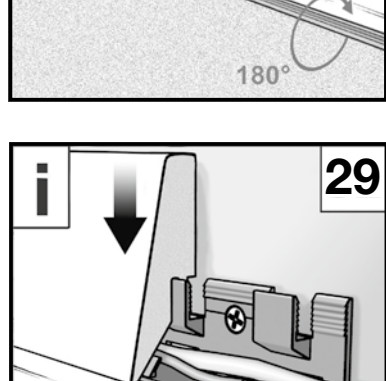
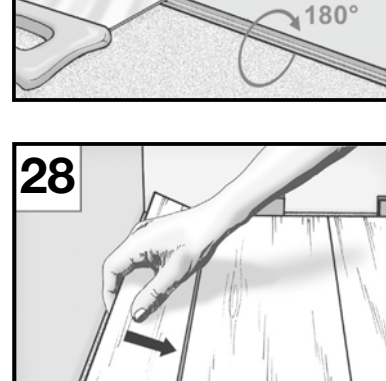
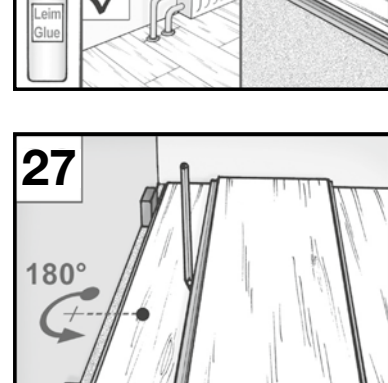
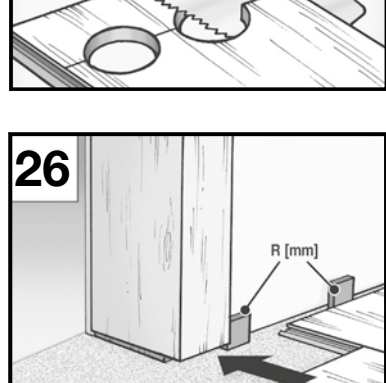
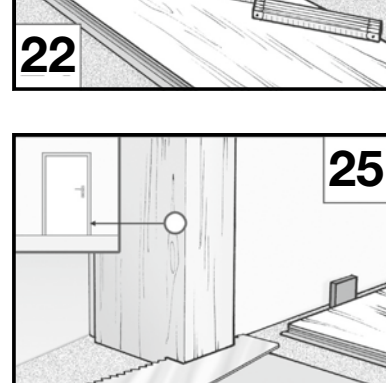
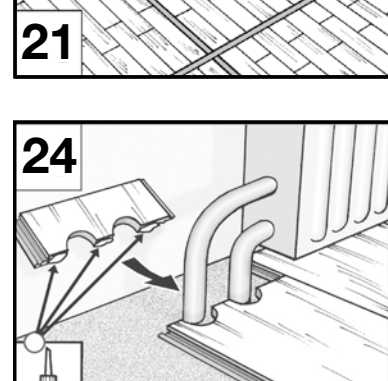
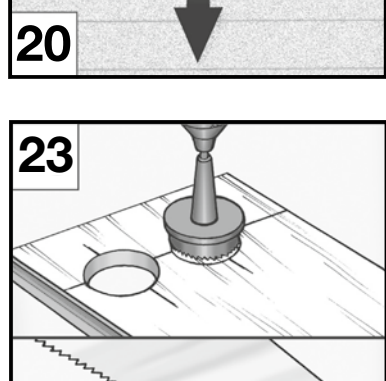
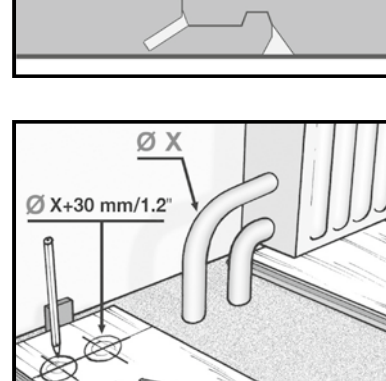
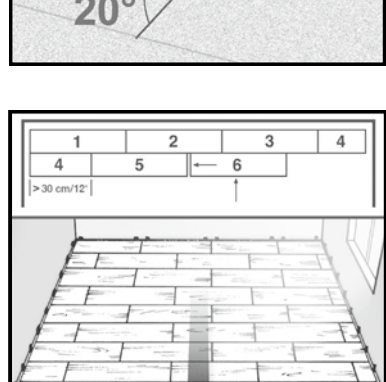
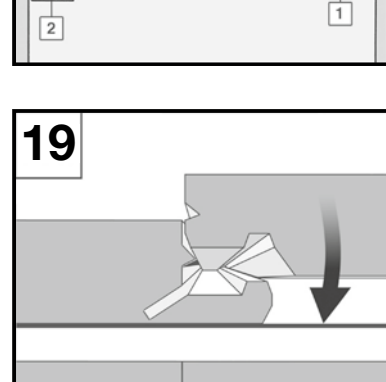
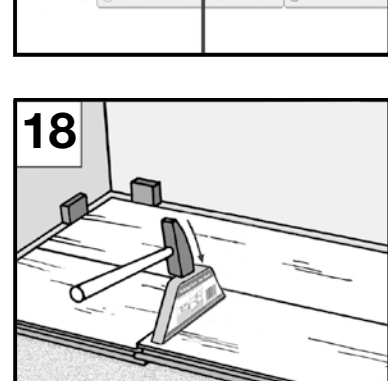
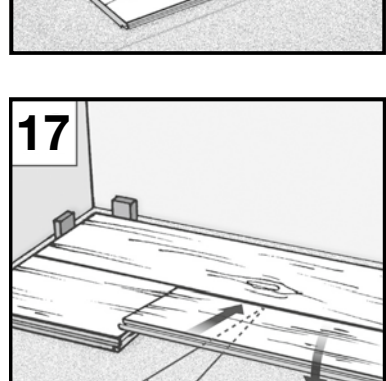
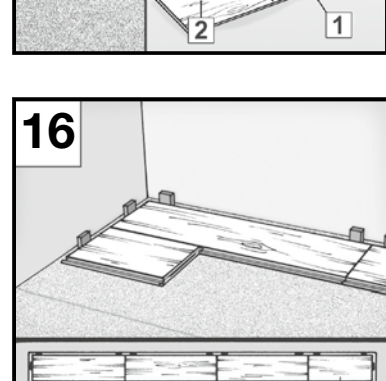
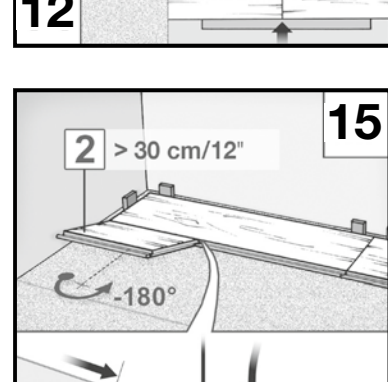
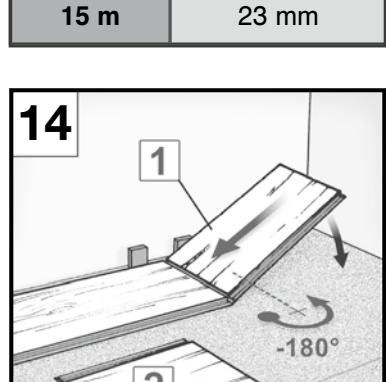
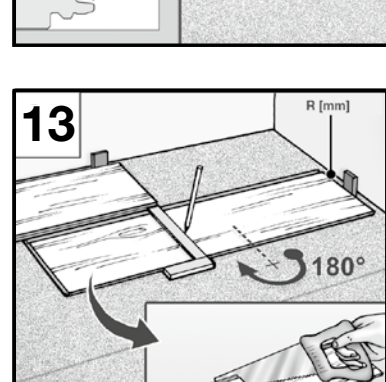
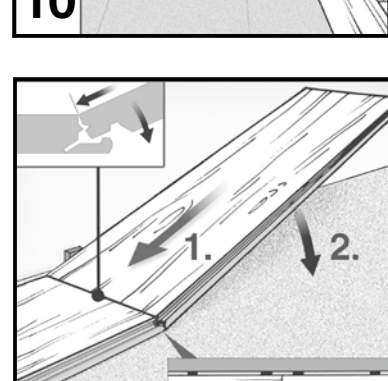

## Disassemblage/Deinstallation/Le désassemblage/Desinstalación:

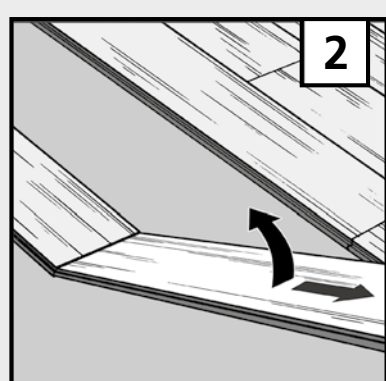
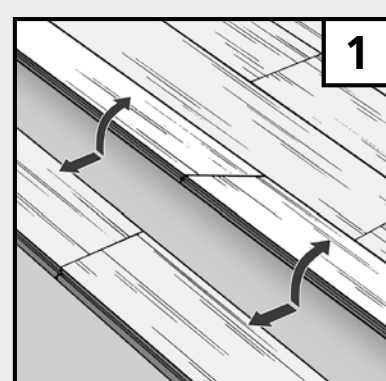

Disposal has to be made via residual waste. Die Entsorgung hat über den Restmüll zu erfolgen. Le produit doit être mis au rebut avec les déchets non recyclables. La eliminación de este producto deberá realizarse a través de desecho inorgánico.